

ALL0484WMP

24 Port 10/100 + 2 Combo Gigabit FX/SFP Nway PoE Switch

FCC Warning

This device has been tested and found to comply with limits for a Class B digital device, pursuant to Part 2 and 15 of FCC Rules. These limits are designed to provide reasonable protection against harmful interference when the equipment is operated in a commercial environment. This equipment generates and radiates radio frequency energy and, if not installed and used in accordance with the user's manual, it may cause interference in which case users will be required to correct interference at their own expenses.

CE Warning

This is a Class B product. In a domestic environment, this product may cause radio interference in which case the user may be required to take adequate measures.

Introduction

This switch provides 24 10/100Mbps NWAY RJ-45 ports and can support 2 Combo Gigabit Copper/SFP to uplink.. It was designed for easy installation and high performance in an environment where traffic is on the network and the number of users increases continuously.

It consists of 24 PSE/PoE ports. That can solve the limitation of the power outlet location and offer the system designer a flexible solution to locate the network device everywhere.

The rack-mount size was specifically designed for medium to large workgroups. The switch can be installed where space is limited; moreover it provides smooth network migration and easy upgrade to network capacity. The 19" size can be rack-mount on 19" cabinet.

Key Features

- Provides 24 10/100Mbps Gigabit switching ports and 2 Combo Gigabit Copper/SFP
- 24 PSE/PoE function ports
- Supporting the power Max. 15.4 W for each PSE/PoE port
- 19" rack-mount size
- Non-blocking & Non-head-of-line blocking full wire speed forwarding
- Store-and-forward operation support
- Embedded 2.75 Mb packet buffer
- Provides 4K MAC address entry
- Supports broadcast storm filtering
- All ports provide Auto-Negotiation and Auto-MDI/ MDI-X functions
- Supports flow control: back pressure for Half-duplex and IEEE 802.3x for Full-duplex mode
- Smart plug & play



Package Contents

Before you start to install this Switch, please verify your package contain the following items:

- One Rack-mount Switch
- Rack-mount Kit for Rack Installation
- One AC Power Cord
- One User's Manual

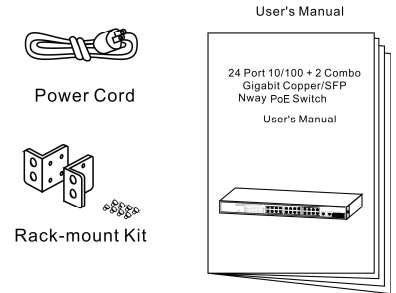

Note: If any of these items is found missing or damaged, please contact your local supplier for replacement.

Front Panel (LEDs)

LED Indicators of 24 Port + 2 Combo Gigabit Copper/SFP PoE Switch

LED	Status	Description	No. Of LED
Power	On	Power on	Power
1000M	On	Link 1000Mbps	2 (25~26)
	off	Link 10/100Mbps	
Link/ ACT	On	Link	26 (1~26)
	Flashing	Data activating	26 (1~26)
PoE	On	Port is linked to Power Device	24 (1~24)
	Off	No Power Device is connected	24 (1~24)

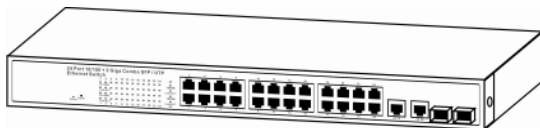

User's Manual

Connections

PC/Other devices to this 24 Port + 2 Combo Gigabit Copper/SFP PoE Switch

Via a twisted pair cable straight through, this switch can be connected to PCs, servers and other network devices.

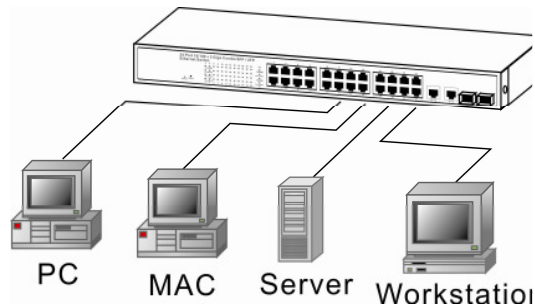

Power Device to this 24 Port + 2 Combo Gigabit Copper/SFP PoE Switch and getting 48V power source through Cat. 5 cables

Using Cat. 5 twisted-pair cable to connect Power Device to the port 1~24 of this switch, and then this switch will supply 48V power to Power Device over Cat. 5 twisted-pair cable. Please be noted Power Device should also comply with IEEE 802.3af.

Technical Specifications

Standards	IEEE 802.3 10BaseT IEEE 802.3u 100BaseTX IEEE 802.3ab 1000BaseT IEEE 802.3z IEEE 802.3af IEEE 802.3x Flow control
Features	Number of Ports: 10/100BaseTX with PSE/PoE RJ-45 Connectors: 24 10/100/1000BaseT with RJ-45 Connectors: 2 Combo SFP Open Slots: 2 MAC Address: 4K Buffer Memory: 2.75 Mb Method: Store and Forward
Filtering/ Forwarding Rates	1000Mbps port – 1,488,000pps 100Mbps port – 148,800pps 10Mbps – 14,880pps
Transmission Media	10BaseT Cat. 3, 4, 5 UTP/STP 100BaseTX Cat. 5 UTP/STP 1000BaseT Cat. 5E UTP/STP
LED Indicators	Per Port: LINK/ACT, PoE ACT/Status Per Unit: Power
Power Requirement	90~260V/AC, 50~60Hz
Power Consumption	390 Watts (Max)
Dimensions	440 × 220 × 44 mm (L x W x H)
Weight	4.7kg
Operating Temperature	0 to 55 °C
Storage Temperature	-20 to 90 °C
Humidity	10 to 90% RH (non-condensing)
Certifications	FCC Class A, CE

Rear Panel (Power)

AC input

AC input (90~260V/AC, 50~60Hz) UL Safety

